



HALCYON

— THE PALATIAL PEAK —

AN EMBLEM OF ELEGANT LIVING



Experience a fairytale marvel in the mould of a home, where life reverberates with discernible pleasure. Halcyon is the cynosure of all eyes and lifts your spirits to touch a new high every day. Come, experience life in its sublime form only at Halcyon, which is a highly acclaimed and impeccable home.

Highlights



Location

Located at the crest of Jubilee Hills. Enjoy spectacular 360-degree views of the city line and move in with the crème de la crème of the society.



Design

High-end architecture, with wooden cladding and glass. Every single feature covering space, balance, light, elevation, look and feel is perfectly taken care of. It's a complete experience!



Great Views

Halcyon enables you to capture the surrounding beauty with your natural lenses. Located at a height, experience magical moments when you just open the window to catch a glimpse of the city line.



Amenities

Clubhouse, Swimming Pool, Mini Theatre, Gym, Spa, Library, Coffee Shop and many more.

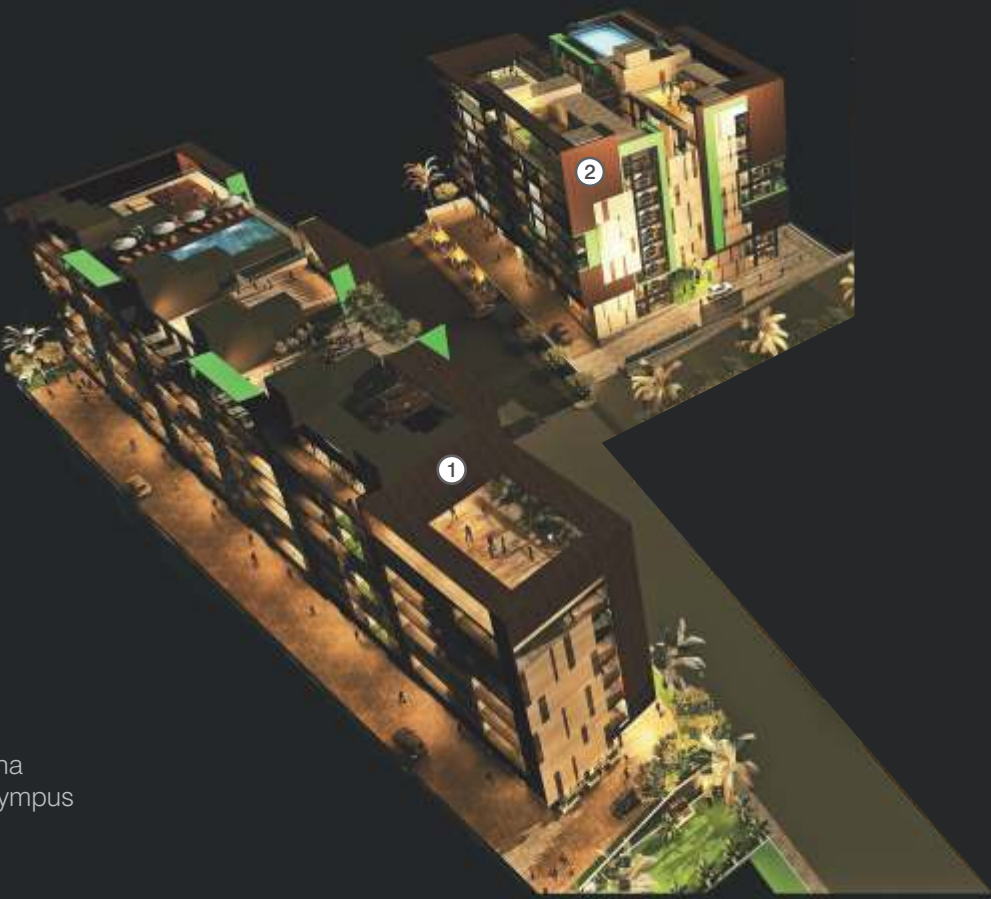

- 
- 1 Etna
 - 2 Olympus

High on design

The design of Halcyon emerges from a powerful, well-orchestrated architecture. Every detail inspires you to the core. The holistically planned design makes room for every single feature such as space, balance, light, elevation, look and feel to lend more aestheticism to the project. Halcyon has three designer apartment blocks Etna and Olympus.

It is our way of pampering you with irresistible choices.

Etna : G+7 Floors

Olympus : G+7 Floors

Fuji : Launching soon



Fuji
Launching soon



Superior-style luxury on the **Outside...** and **Inside.**

Halcyon makes its extravagant stance at the most sought-after address, Jubilee Hills. It is designed to offer unparalleled, unhindered and breathtaking views of the serene surroundings and urban landscape on its horizon.

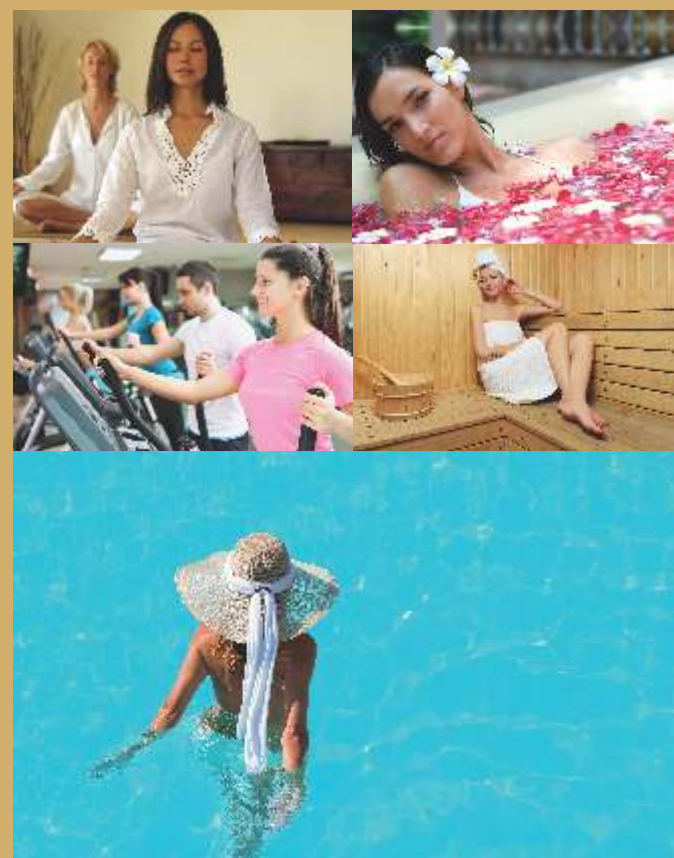

High on amenities

ETNA BLOCK

Terrace

Coffee Lounge | Indoor Seating | Outdoor Seating | Washroom | Party Lounge | Swimming Pool | Deck | Changing Rooms | Gymnasium | Open Meditation Area | Washroom | Multi-purpose Area

Podium & OSR

Themed Lawn With Seating Area | Half Basket Ball Court | Toddlers Play Area | Themed Entrance Landscape | Jogging Track | Car Free Zone | Hardscapped Pathway | Gazebo Space

OLYMPUS BLOCK

Terrace

Coffee Lounge | Indoor Seating | Outdoor Seating | Washroom | Swimming Pool | Deck | Changing Rooms | Gymnasium | Open Meditation Area / Multi-purpose Play Court | Washroom | Party Lounge

Podium & OSR

Jogging Track | Car Free Zone | Hardscapped Pathway | Themed Landscape

ETNA - 103

BLOCK - 3

4 BHK, 3500 SQ.FT.

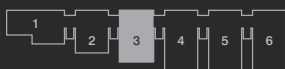

ETNA - 105

BLOCK - 5

4 BHK, 4082 SQ.FT.

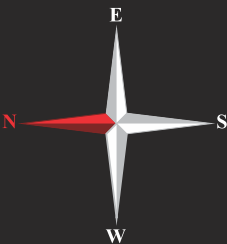
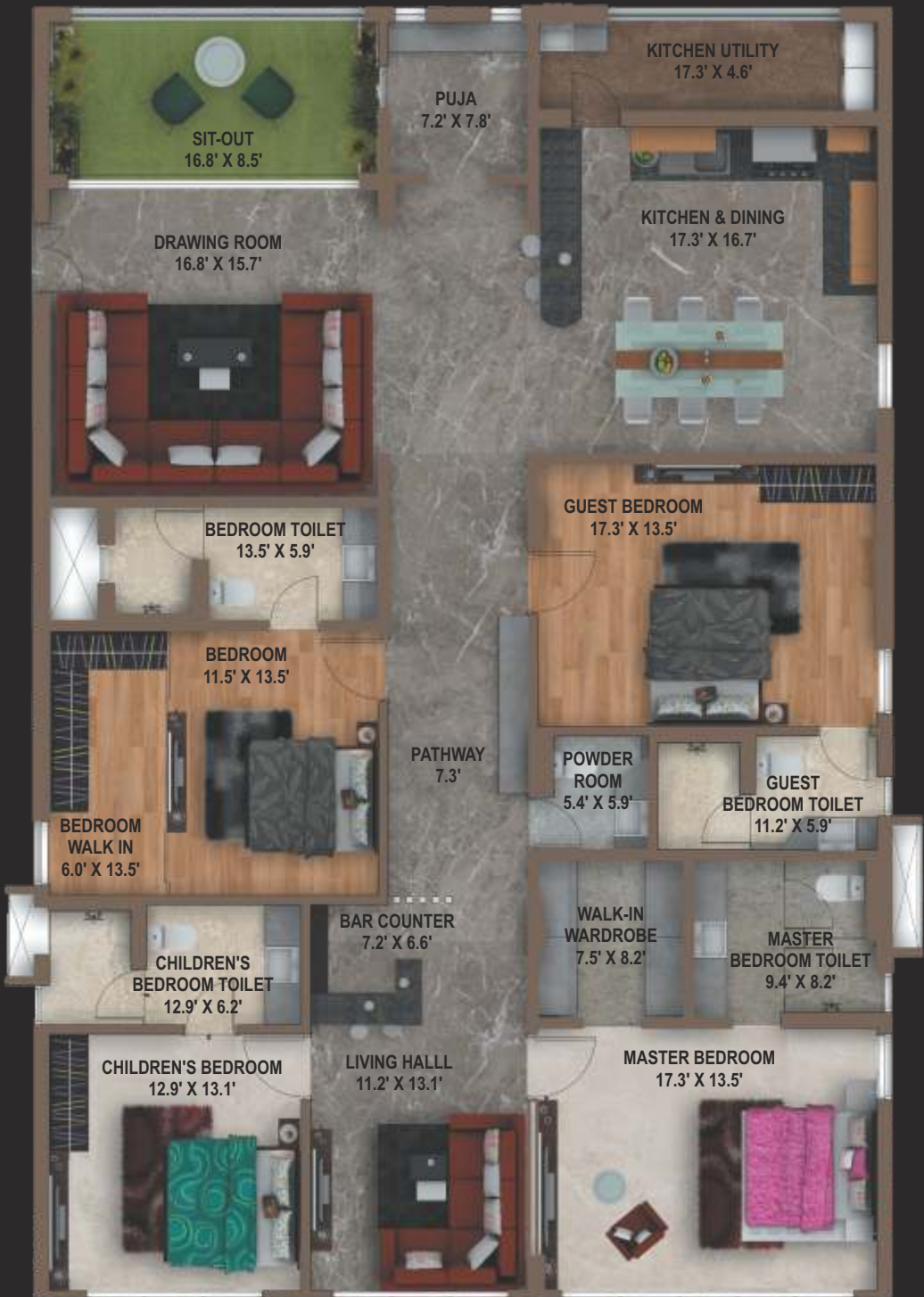

ETNA - 202

BLOCK - 2

3 BHK, 3537 SQ.FT.

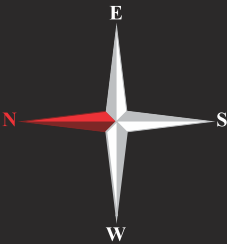

ETNA - 605 & 705

BLOCK - 5

4 BHK, 4897 SQ.FT.

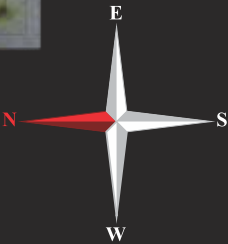

ETNA - 703

BLOCK - 3

4 BHK, 4330 SQ.FT.

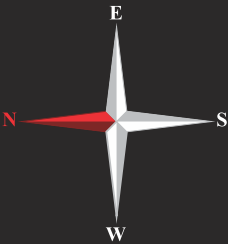

OLYMPUS - 001 & 101

BLOCK - 1

4 BHK, 4127 SQ.FT.

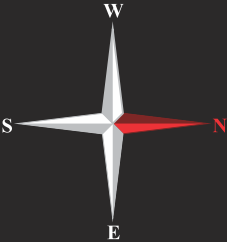

OLYMPUS - 004 & 104

BLOCK - 4

4 BHK, 4127 SQ.FT.



OLYMPUS - 103

BLOCK - 3

4 BHK, 4127 SQ.FT.



OLYMPUS - 401 & 601

BLOCK - 1

4 BHK, 4725 SQ.FT.

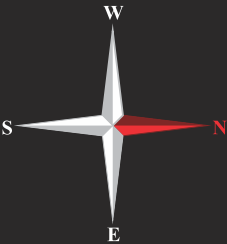

OLYMPUS - 403

BLOCK - 3

4 BHK, 5190 SQ.FT.

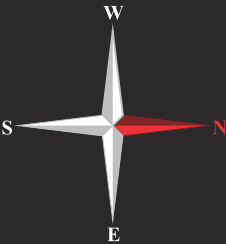

OLYMPUS - 404

BLOCK - 4

4 BHK, 4725 SQ.FT.

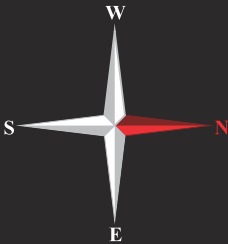

Specifications

STRUCTURE:

PEB Steel framed structure with Earthquake resistance.

INTERNAL AND EXTERNAL WALLS:

Walls - Lightweight block Masonry

TERRACE ROOF:

Terrace slab is insulated and waterproofed.

FLOORING:

Living areas : Imported Marble

Bedrooms : Engineered wood/ Imported Marble

Dining and Kitchen : Imported Marble

Utility : Anti-skid tiles

Toilets : Imported tiles for dadoing and Anti-skid tiles for flooring

Balcony : Anti-skid tiles

FALSE CEILING:

Toilets : False Ceiling

PAINTS:

All internal walls are finished with putty and painted with Royal Plastic Emulsion

SANITARY AND PLUMBING:

Sanitary Ware : Villeroy and Boch

CP Fittings : Villeroy and Boch

DOORS:

Main Door : Alumil ANIMA series doors with hardware set

Internal and Toilet doors : Alumil LINEAR series doors with hardware set

Sliding Doors: Alumil sliding doors at sit-out area and balcony areas with provision for mosquito mesh track

Windows: Alumil brand aluminium frame windows with provision for mosquito mesh track (for sliding type windows)

HOME AUTOMATION: Provision

INTERCOM: Provision

Nestled Atop the Hill At a Convenient Setting.

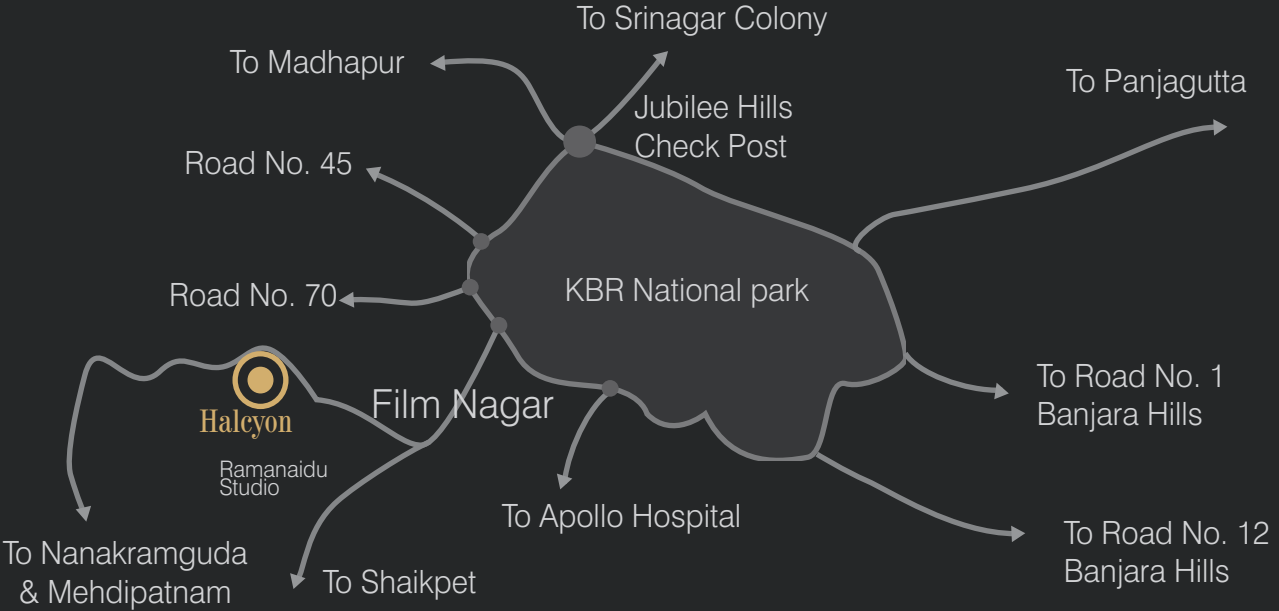

Site Address: Phoenix Residences Pvt Ltd. 403(P), T.S.No.1, Block -F, ward 9, Road no.78, Jubilee Hills, Hyderabad- 500033

Corporate address: Phoenix house, Plot no 1335, Road no. 45, Jubilee Hills, Hyderabad- 500033

Call : +91 80813 33555 | **e-mail:** sales@halcyonphoenix.com | www.halcyonphoenix.com

Note: This brochure is purely conceptual and is not a legal document. Phoenix Residences Pvt. Ltd. reserves the right to add/modify any terms and conditions, amenities/ facilities, specification and plans mentioned herein.